

Fuse link, SEV G4 500V (gG)



See below:

[Approvals and Compliances](#)

Description

- According to IEC 269
- According to EN 60269
- Selectivity 1:1.6
- Removal tags energized
- Dimensions according to SNV 24482

Unique Selling Proposition

- Characteristic gG
- Full-range fuse-links for general applications

Weblinks

[pdf data sheet](#), [html datasheet](#), [Detailed request for product](#)

Technical Data

Rated Current In	40- 400A
Rated Voltage	500VAC
Breaking Capacity	120 kA
Rated Power Operating Frequency	50Hz

Basic Design

Insulator	Ceramics
Metal components	corrosion-resistant (rustproof)

Power Dissipation (Watt) operating temperature max.

The power dissipation is the so called power loss at rated current load and operation temperature acc. VDE 0636 . It is to be measured in Watt at AC condition. The voltage tap is to be assured that the power dissipation of the blade contacts are included. This means the measure contact need to be applied at the ends of the blade contacts. The standard VDE 0636 part 1 and 2 requires that following maximal permissible power losses are not exceeded.

Approvals and Compliances

Detailed information on product approvals, code requirements, usage instructions and detailed test conditions can be looked up in [Details about Approvals](#)

Compliances

The product complies with following Guide Lines

Identification	Details	Initiator	Description
REACH	REACH	SCHURTER AG	On 1 June 2007, Regulation (EC) No 1907/2006 on the Registration, Evaluation, Authorization and Restriction of Chemicals 1 (abbreviated as "REACH") entered into force.

Dimensions [mm]

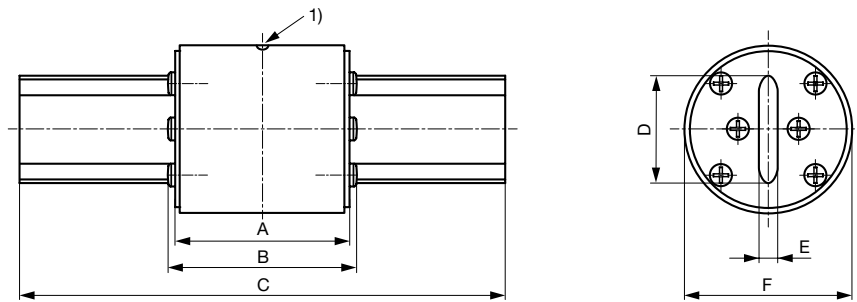

SEV	A	B	C	D	E	F
2	53	58	134	25	5	45
4	61	65	162	35	6	55
6	66	70	188	42	8	70

1) Indicator

Time-Current-Curves

SEV G2 - G6

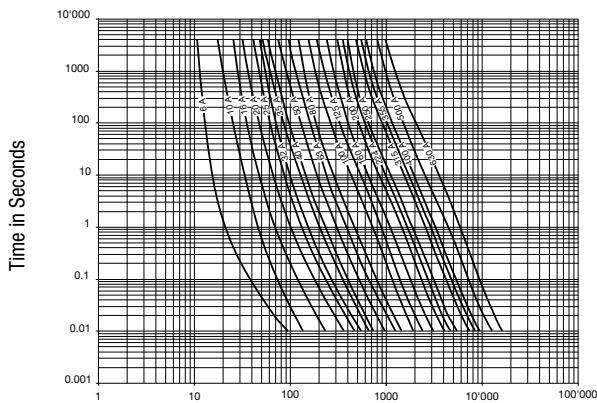

Current in Amperes

All Variants

Rated current [A]	Style [Compact]	Power Loss [W]	Order Number	E-No.
40	-	-	0001.4313	840111149
63	-	-	0001.4315	840111179
80	-	-	1301.2212	840111199
100	-	-	1301.2213	840111209
125	-	-	1301.2214	840111219
160	-	-	1301.2215	840111239

Rated current [A]	Style [Compact]	Power Loss [W]	Order Number	E-No.
200	-	-	1301.2216	840111249
250	-	-	1301.2217	840111269
315	-	-	1301.2218	840111289
355	-	-	0001.4316	840111299
400	-	-	1301.2219	840111309

Most Popular.

Availability for all products can be searched real-time:<https://www.schurter.com/en/Stock-Check/Stock-Check-SCHURTER>

Packaging unit 3 Pcs